

Fastening Technology / Threaded Inserts

TIBOLT®

Blind Rivet Studs

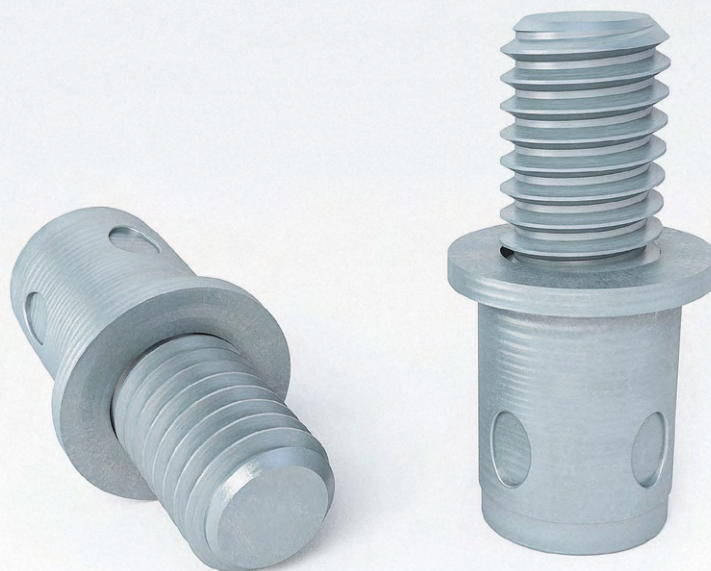

Copyright

All texts, images, technical documents and other information contained in this catalogue are subject to copyright held by Titgemeyer GmbH & Co. KG. Any reproduction or disclosure, whether as a copy or other form of duplication or use, is expressly prohibited without the prior consent of Titgemeyer GmbH & Co. KG.

Registered trademarks

The trademarks BÖRTI, GETO, GETO therm, GETOVAN, GTO, LockBolt, MEGA PORT, plasti van, PLYFIX, POLYSTIC, press-ti, RIEKO, RIV-TI, ROLL-TO, TIBOLT, TIBULB, TIFAS, TILA, TIOS and Titgemeyer are registered trademarks and the intellectual property of Titgemeyer GmbH & Co. KG.

Term of Delivery and Payment

All deliveries are carried out in compliance with our Terms of Delivery and Payment.

Limitation of liability

All technical data, performance descriptions, drawings, illustrations, measurements, weights or any other performance data, recommendations and guidelines contained in this catalogue and relating to the installation of parts that we supply are only binding if so expressly agreed. Moreover, the user is obliged at all times to check each individual use and decide whether the components that we supply can be used as needed.

We accept liability in the case of wilful intent, gross negligence and infringement of cardinal contractual duties as well as for errors in respect of express or implied representations. Notwithstanding this, any claims for compensation not explicitly agreed to in these terms and conditions are hereby excluded in the case of customers who are not consumers and, in the case of such customers, who are not consumers, at all events limited to the damage foreseeable at the time of concluding the contract as well as to the value of the delivered consignment. To the extent that our liability is excluded or limited, this shall extend accordingly to the personal liability of employees, legal representatives and vicarious agents. In all instances of gross negligence committed by vicarious agents, we shall solely be liable to customers, who are not consumers, to compensate for typically foreseeable damage. The statutory regulation governing the burden of proof shall remain unaffected. The aforementioned limitation of liability shall not apply to claims resulting from product liability, for damage resulting from injury to life, limb or health, or for damage to privately used property.

Contents

Seite

TIBOLT® blind rivet studs	Overview		4
	Flat head	Steel, galvanised	6
	Countersunk head	Steel, galvanised	7

TIBOLT® blind rivet studs



TIBOLT® blind rivet studs are the alternative to weld studs or threaded self-clinching studs. The sleeve and stud are cold welded together. This welding process performs the double function of forming a twist-resistant joint between the two components while also holding the upset on the blind end of the rivet. Without this, the body that forms during the rivet installation process would drag the material away from the stud head. The welding process ensures that the blind rivet studs offer absolute stability and load-bearing capacity. The term 'absolute' here means that the stud, and not the rivet connection, gives way when overloaded. Upon installation, blind rivet studs can therefore be subjected to the same loads as same-quality DIN studs.

The TIBOLT® is installed from one side. This is both rational and time-saving, especially for components that are difficult or impossible to access from the blind side. Highly practical: as a result of this strong rivet installation process, it is also possible to fasten further sheet panels to the component. By attaching commercially available nuts, the protruding thread on the blind rivet stud will support any other installed fasteners. Blind rivet studs are supplied in 8.8 mating screw proof load quality. Their installation using hand lever or hydropneumatic installation tools is extremely easy, fast, and material-friendly. Surface-finished components can also be installed without being damaged. The same tools can be used as for blind rivet nuts, with only the threaded mandrels needing to be replaced with internal threaded mandrels.

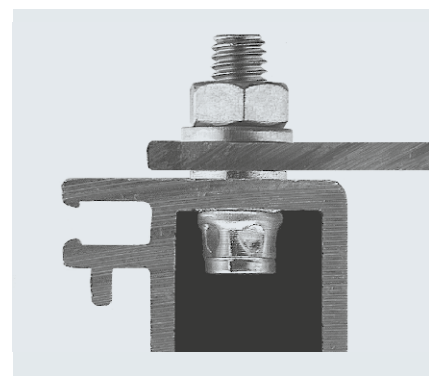
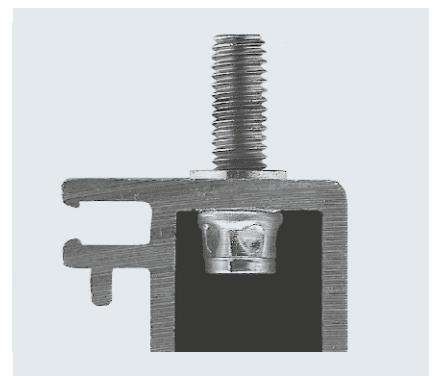

Benefits at a glance

- One-sided access
- No thermal action on the base material, therefore no deforming or discolouring as occurs with welding, for example
- Replaces weld bolts or threaded self-clinching studs
- Enables the component to be pre-attached to the base component before fastening

Easy, rational and time-saving installation

1. Prepare the drilled hole.
2. Screw the TIBOLT® into the internal threaded mandrel of the rivet installation tool.
3. Insert the TIBOLT® blind rivet stud into the drilled hole.
4. The rivet installation tool retracts the internal threaded mandrel and rivets the TIBOLT® axially to the component. Hold the rivet installation tool squarely to the component when performing the installation.
5. Spin off the internal threaded mandrel.
6. The TIBOLT® is now ready to be used to support additional fasteners. For best twist-proof results, the attached parts must rest very flush on the head of the TIBOLT® blind rivet stud.

Form of delivery

Head type:	Flat or countersunk head
Threads:	M 4, M 5, M 6, M 8
Material	
Sleeve:	C4C steel
Material	
Stud:	1.5523 steel (property class 8.8)
Finish:	5 - 8 µm galvanised and passivated, Cr-6 free, RoHS-compliant

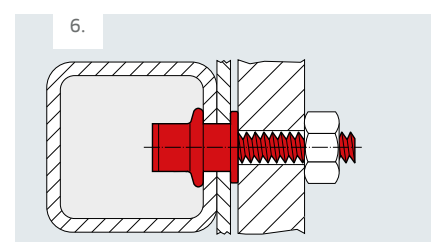
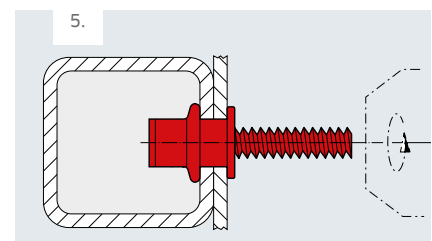
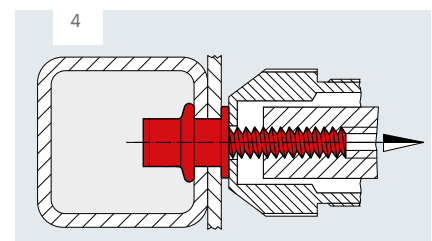
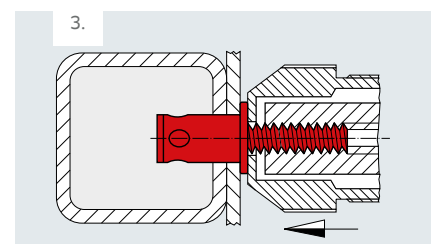
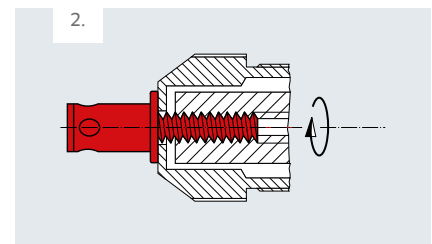
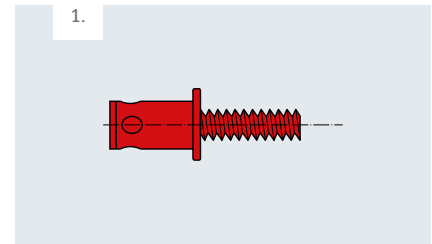

TIBOLT® blind rivet studs

Flat head

Material

Steel, galvanised

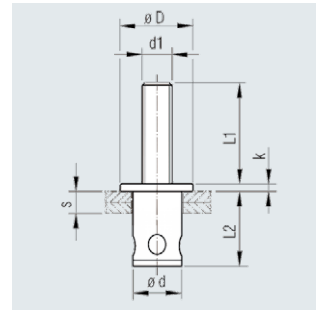
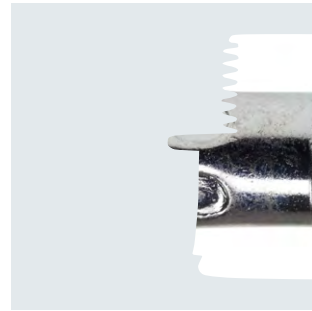

Thread size d1	Grip range s [mm]	Hole ø [mm]	Thread length L1* [mm]	Shank ø d max [mm]	Head ø D [mm]	Head height k [mm]	Shank length L2 [mm]	Article No.
M4	0.2 - 1.8	5.5	8.0	5.4	8.0	0.5	8.0	332 402 000
			15.0	5.4	8.0	0.5	8.0	332 405 000
M5	0.2 - 1.8	6.6	10.0	6.5	9.0	0.75	9.0	332 503 000
			15.0	6.5	9.0	0.75	9.0	332 505 000
	2.0 - 3.3	6.6	10.0	6.5	9.0	0.75	10.5	332 513 000
			15.0	6.5	9.0	0.75	10.5	332 515 000
M6	0.3 - 2.2	7.8	10.0	7.7	10.0	1.0	10.0	332 603 000
			15.0	7.7	10.0	1.0	10.0	332 605 000
			20.0	7.7	10.0	1.0	10.0	332 607 000
			10.0	7.7	10.0	1.0	11.5	332 613 000
			15.0	7.7	10.0	1.0	11.5	332 615 000
			20.0	7.7	10.0	1.0	11.5	332 617 000
	2.5 - 3.8	7.8	10.0	7.7	10.0	1.0	11.5	332 623 000
			12.0	7.7	10.0	1.0	13.5	332 624 000
			15.0	7.7	10.0	1.0	13.5	332 625 000
			20.0	7.7	10.0	1.0	13.5	332 627 000
			15.0	9.8	12.0	1.5	12.5	332 805 000
			20.0	9.8	12.0	1.5	12.5	332 807 000
M8	0.3 - 2.8	9.9	25.0	9.8	12.0	1.5	12.5	332 808 000
			15.0	9.8	12.0	1.5	15.0	332 815 000
			20.0	9.8	12.0	1.5	15.0	332 817 000
	3.0 - 4.8	9.9	25.0	9.8	12.0	1.5	15.0	332 819 000
			25.0	9.8	12.0	1.5	15.0	332 819 000

* L1= Dimensions will vary depending on the grip range and tool settings.

Further designs available on request.

TIBOLT® blind rivet studs

90° countersunk head

Material

Steel, galvanised

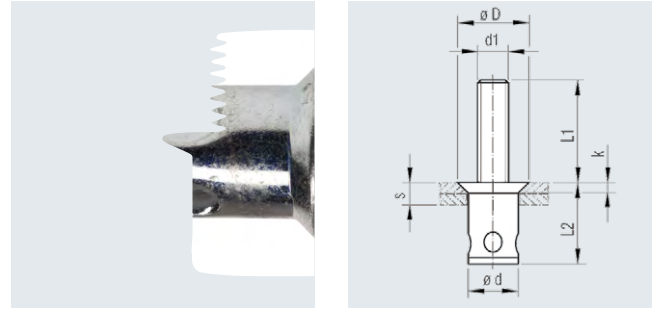

Thread size d1	Grip range s [mm]	Hole ϕ [mm]	Thread length L1* [mm]	Shank ϕ d max [mm]	Head ϕ D [mm]	Head height k [mm]	Shank length L2 [mm]	Article No.
M4	1.6 - 2.3	5.5	15.0	5.4	8.0	1.5	8.5	332 455 000
M5	1.5 - 2.8	6.6	10.0	6.5	9.0	1.4	10.0	332 553 000
			15.0	6.5	9.0	1.4	10.0	332 555 000
M6	1.5 - 3.2	7.8	10.0	7.7	10.0	1.3	11.0	332 653 000
			15.0	7.7	10.0	1.3	11.0	332 655 000
			20.0	7.7	10.0	1.3	11.0	332 657 000
M8	1.5 - 3.8	9.9	15.0	9.8	12.0	1.3	13.5	332 855 000
			20.0	9.8	12.0	1.3	13.5	332 857 000
	4.0 - 5.3	9.9	15.0	9.8	12.0	1.3	15.0	332 865 000
			20.0	9.8	12.0	1.3	15.0	332 867 000

* L1= Dimensions will vary depending on the grip range and tool settings

When installing the countersunk head version, the drilled hole should only be countersunk deep enough so that the head of the TIBOLT® blind rivet studs protrudes approx. 0.1 mm above the surface.

Further designs available on request.

About us

The Titgemeyer Group is a leading company for fastening technology and vehicle components at 15 locations in Europe.

The traditional company develops, manufactures and sells more than 30,000 fastening elements, tools and vehicle components – in series production and on request.

Headquarters

Titgemeyer GmbH & Co. KG
Hannoversche Straße 97
49084 Osnabrück / DE

PO Box 4320
49033 Osnabrück / DE

T +49 541 5822-0
E info@titgemeyer.com
W titgemeyer.com



Sales locations

Titgemeyer Austria GmbH
Brunner Straße 77 - 79
1230 Wien / AT

T +43 (0) 1/6 67 90 40 - 0
E sales@titgemeyer.com
W titgemeyer.at

Titgemeyer CZ spol. s r. o.
U Vodárny 1506
397 01 Písek / CZ

T +420 382 2067 - 25
E sales@titgemeyer.com
W titgemeyercz.cz

Titgemeyer Polska sp. z o.o.
Cypriana Bazylika 17
98-200 Sieradz / PL

T +48 (0) 43 828 20 - 15
E sales@titgemeyer.com
W titgemeyer.pl

Titgemeyer Skandinavien A/S
Lunikvej 32
2670 Greve / DK

T +45 4360 0966
E info@titgemeyer.dk
W titgemeyer.dk

Titgemeyer Skandinavien A/S
Box 3218
550 03 Jönköping / SE

T +46 36 128350
E info@titgemeyer.se
W titgemeyer.se

Titgemeyer Skandinavien A/S
Korkeakoulunkatu 7
33720 Tampere / FI

T +358 (0) 400 448 401
E info@titgemeyer.fi
W titgemeyer.fi

Titgemeyer Turkey Baglanti Teknolojileri San. ve Tic. A.S.
Barbaros Mah. Is Merkezi No.1
Kat: 8 D.58
34746 Atasehir, Istanbul / TUR

T +90 (0) 21 66 88 20 - 27
E sales@titgemeyer.com.tr
W titgemeyer.com.tr

Titgemeyer (UK) Limited
A2 Link One Industrial Park
George Henry Road
DY4 7BU Tipton / UK

T +44 (0) 1 21 5 57 97 - 77
E sales@titgemeyer.co.uk
W titgemeyer.co.uk

Production sites

Cirteq Limited
'Hayfield' Colne Road,
Glusburn, Keighley,
West Yorkshire, BD20 8QP

T +44 1535 633333
E sales@cirteq.com
W cirteq.com

Titgemeyer Tools & Automation spol s.r.o.
U Vodárny 1506
397 01 Písek / CZ

T +42 382 2067 - 11
E info@rivetec.cz
W rivetec.cz

RIEKO GmbH
Robert-Bosch-Straße 9
72124 Pliezhausen / DE

T +49 7127 9744 - 0
E info@rieko-web.com
W rieko-web.com

Titgemeyer GmbH & Co. KG Werk Lotte
Daimlerstraße 13 - 15
49504 Lotte / DE

T +49 5404 9666 - 0
E info@titgemeyer.com
W titgemeyer.com

TS Gesellschaft für Transport- und Sicherungssysteme mbH
Haßlinghauser Straße 156
58285 Gevelsberg / DE

T +49 541 5822 - 900
E ts@cargocontrol.de
W wir-sind-ladungssicherung.de